

MATERIAL: 14 GAUGE
STAINLESS STEEL
(0.075")

FINISH: SAND
LEFT TO RIGHT
ON SIDE OPPOSITE
STUDS

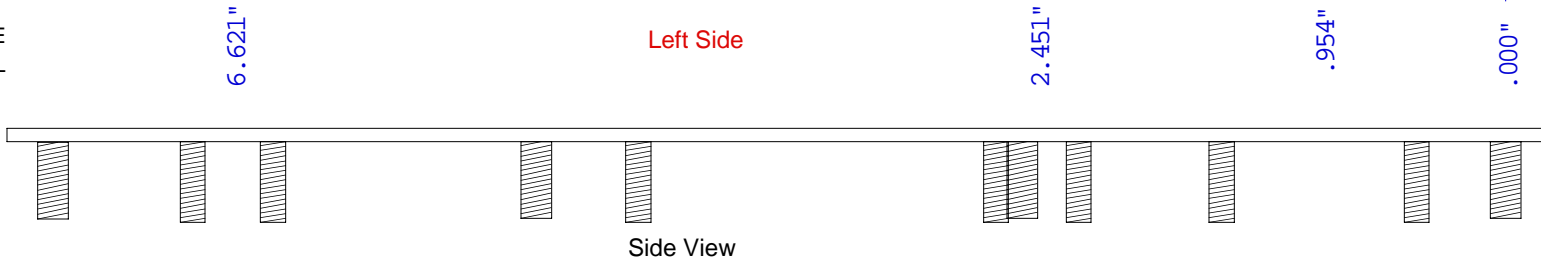

Side View

TI Texas Industrial Peripherals
2621 Ridgepoint Dr. Suite 130
Austin, Texas 78754
Voice: (512) 837-0283
Fax: (512) 837-0207

Part Number: **PM-18-1330**
Drawing Title: **Top Veiw of Bezel**

Drawing Number:
Revision: **1.000**

Sheet: **1 of 3**
Date: **3.19.01**
JKH

